

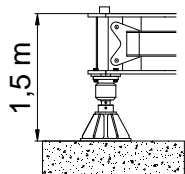

TLS 6510B-10T

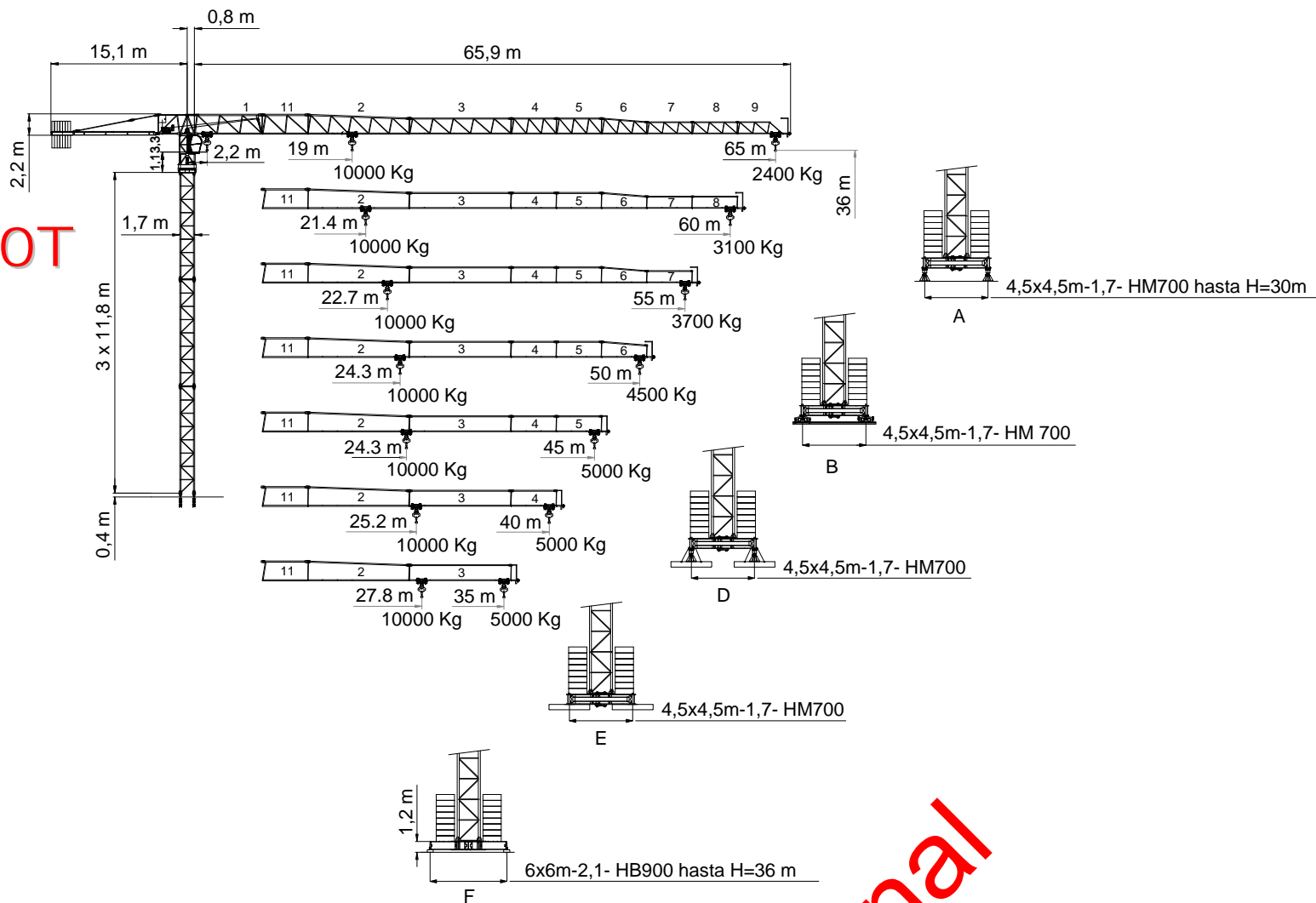

A

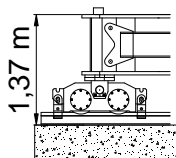

B(OPTIONAL)

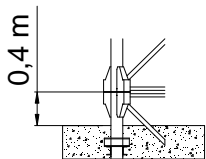

C

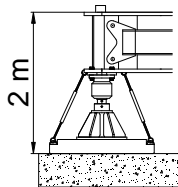

D

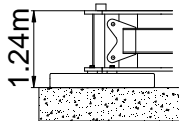

E(4.5x4.5)

Provisional

DIN/FEM

EN 14439-FEM 1005- C25

REV 000. MARZO 2012

Viento max. fuerza de servicio 150km/h

Curvas de cargas
Load diagrams
Lastkurven
Courbes de charges
Curve di carico

65 m

10	15	20	25	30	35	35.6	40	45	50	55	60	65
5000	5000	5000	5000	5000	5000	5000	4368	3795	3340	2969	2660	2400

m
Kg

10	15	19	20	25	30	35	40	45	50	55	60	65
10000	10000	10000	9471	7317	5905	4909	4168	3595	3140	2769	2460	2200

m
Kg

60 m

10	15	20	25	30	35	40	40.2	45	50	55	60
5000	5000	5000	5000	5000	5000	5000	5000	4385	3869	3449	3100

m
Kg

10	15	20	21.4	25	30	35	40	45	50	55	60
10000	10000	10000	10000	8398	6800	5672	4833	4185	3669	3249	2900

m
Kg

55 m

10	15	20	25	30	35	40	42.6	45	50	55
5000	5000	5000	5000	5000	5000	5000	5000	4693	4146	3700

m
Kg

10	15	20	22.7	25	30	35	40	45	50	55
10000	10000	10000	10000	8963	7267	6071	5181	4493	3946	3500

m
Kg

50 m

10	15	20	25	30	35	40	45	45.6	50
5000	5000	5000	5000	5000	5000	5000	5000	5000	4500

m
Kg

10	15	20	24.3	25	30	35	40	45	50
10000	10000	10000	10000	9685	7866	6581	5626	4888	4300

m
Kg

Provisional

Curvas de cargas
Load diagrams
Lastkurven
Courbes de charges
Curve di carico

45 m

10	15	20	25	30	34	35	40	45	m
5000	5000	5000	5000	5000	5000	5000	5000	5000	Kg



10	15	20	24.3	25	30	35	40	45	m
10000	10000	10000	10000	9708	7884	6597	5640	4900	Kg



40 m

10	15	20	25	30	35	35.3	40	m
5000	5000	5000	5000	5000	5000	5000	5000	Kg



10	15	20	25	25.2	30	35	40	m
10000	10000	10000	10000	10000	8234	6896	5900	Kg



35 m

10	15	20	25	30	35	m
5000	5000	5000	5000	5000	5000	Kg

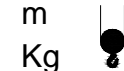

10	15	20	25	27.8	30	35	m
10000	10000	10000	10000	10000	9176	6600	Kg



Provisional

**Mecanismos
Mechanisms
Antriebe
Mécanismes
Meccanismi**

57 Hp (42Kw) - INV-5V
H.B.G 170Mts S/R Ø13

		m/min	0--40	0--46	0--71	0--103	0--20	0--23	0--35	0--51
		Kg	5000	3500	2000	1250	10000	7000	4000	2500
		Kw	33	33	33	33	33	33	33	33

	m/min	11 / 37 / 75			11 / 37 / 75		
	Kw	3,0			3,0		
	r.p.m	0,3	0,6	0,9	0,3	0,6	0,9
	Nm	2 x 65			2 x 65		
	m/min	12 / 24			12 / 24		
	Kw	4 x 3			4 x 3		

- Elevación / Hoisting / Heben / Levage / Sollevamento
- Distribución / Trolleying / Katzfahren / Distribution / Distribuzione
- Orientación / Slewing / Schwenken / Orientation / Rotazione
- Traslacion / Travelling / Schienenfahren / Translation / Traslazione
- Cable / Rope / Seil / Câble / Fune

 2000/14/CEE 2005/88/CEE	 2006/95 /CEE	400 V 50 Hz	100m 4x35mm ²	GENERADOR	POTENCIA INSTALADA
				300 kVA	60 KW
 2000/14/CEE 2005/88/CEE	 2006/95 /CEE	380 V 60 Hz	100m 4x35mm ²	OPCIONAL	

Provisional

Bloque de contrapeso
Counterweight blocks
Gegengewichtsblöcke
Bloc de contrepoid
Blocco di contrappeso

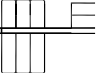
	65 m			60 m			55 m			50 m		
	A	B	C	A	B	C	A	B	C	A	B	C
	8	-	-	8	-	-	7	1	-	6	2	-
	20000 Kg			20000 Kg			19000 Kg			18000 Kg		

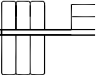
	45 m			40 m			35 m			30 m		
	A	B	C	A	B	C	A	B	C	A	B	C
	6	1	-	6	-	-	4	2	-	3	2	-
	16500 Kg			15000 Kg			13000 Kg			10500 Kg		

TLS 6510B 5-10T

Provisional



FEM 1005-C25 / EN 14439

Mástil / Reacciones
Masts / Reactions
Maste / Eckdrücke
Mat / Réactions
Torre / Reazioni

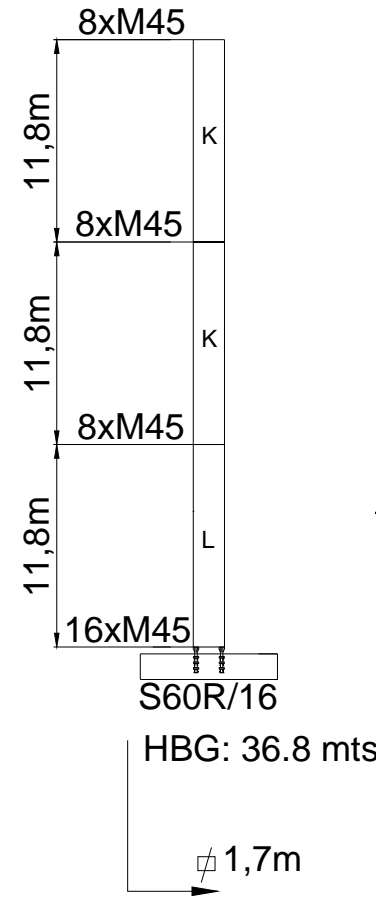
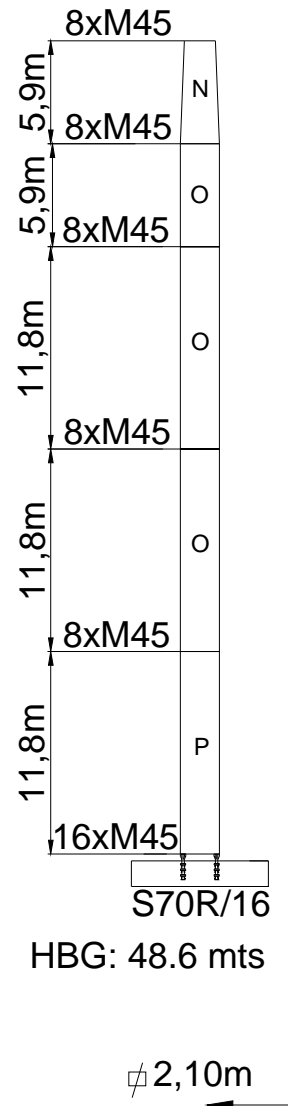

K = S17 8/8
L = S17 16/8
N = S21-S17 8/8
O = S21 8/8
P = S21 16/8

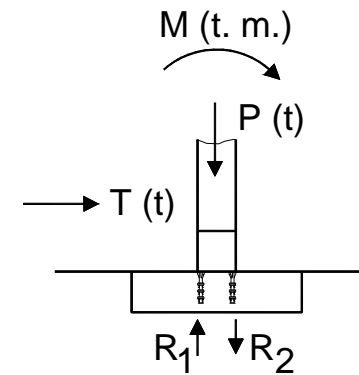

TLS 6510B 5-10T



Provisional

FEM 1005-C25 / EN 14439

Bloque lastre de base
 Base ballast block
 Grundballastblöcke
 Bloc de lest de base
 Blocco di zavorra alla base

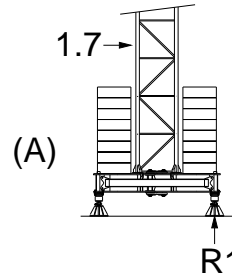

4,5 x 4,5 m-1,7-HM 700	R1 (t)	--
	H (m)	30 m
	Z (t)	--

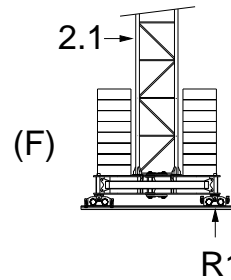

6 x 6 m- 2.1 - HB900	R1 (t)	--
	H (m)	36 m
	Z (t)	--

Provisional

Pluma tramo primero / Jib heel section / Ausleger-Anlenkstück / Pied de fleche /
Settore articolato di braccio

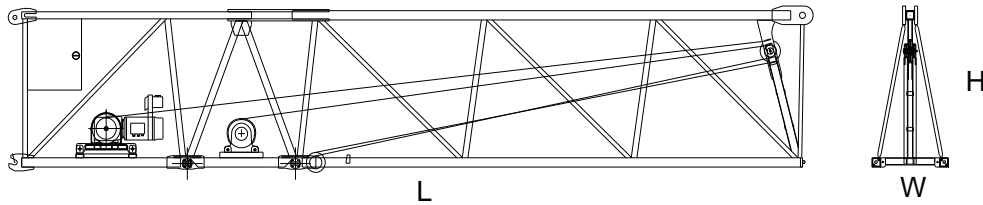

L(m)	W(m)	H(m)	Peso(Kg)
------	------	------	----------

11,90	1.6	2,30	5800
-------	-----	------	------

TLS 6510B 5-10T



Provisional

		L(m)	W(m)	H(m)	Peso(Kg)	
<p>Elemento intermedio de pluma / Intermediate jib section / Ausleger-Zwischenstück Elément interm. de fleche / Spezzone di braccio</p>						
<p>Nº 2</p>						
<p>Nº 3, Nº 4, Nº 5</p>						
<p>Nº 6</p>						
<p>Nº 7, Nº 8, Nº 9</p>						
<p>Nº 11</p>						
		2	11,60	1,5	2,25	2194
		3	11,60	1,5	1,80	1720
		4	5,30	1,5	1,80	620
		5	5,30	1,5	1,80	530
		6	5,30	1,5	1,80	470
		7	5,30	1,5	1,45	376
		8	5,30	1,5	1,45	326
		9	5,15	1,5	1,40	248
		11	5,15	1,5	2,25	1280
<p>Gancho, Carro y Puntera / Hook, Trolley and jib head / Lasthaken - Laufkatze-Cabeça de Lança Crochet - Chariot-Pointe de fleche / Gancio - Carrello e Punta freccia</p>						
		1,20	1,60	0,80	290	
		0,80	0,75	1,50	330	
		0,80	1,60	1,40	108	

Provisional

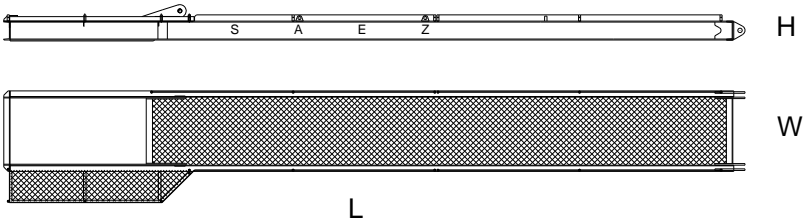
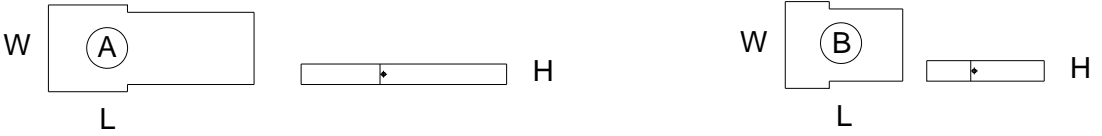
	L(m)	W(m)	H(m)	Peso(Kg)
<p>Contrapluma / Counter-jib / Gegenausleger / Contre-fleche / Controbraccio</p> 	11,94	1,80	0,60	2575
<p>Bloque de contrapeso / Counterweight blocks / Gegengewichtsblöcke / Bloc de contrepoids / Blocco di contrappeso</p> 	3,20 1,83	1,25	0,29	2500 1500

Provisional

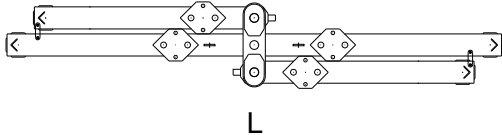
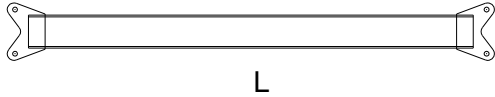
	L(m)	W(m)	H(m)	Peso(Kg)
<p>Base Cruciforme 4,5 X4,5 / Crossbase 4,5 X 4,5 / Fundamentkreuz 4,5 X 4,5 / Châsis 4,5 X 4,5 / Carro base 4,5 X 4,5</p> 	6,70	1,10	1,20	5750
<p>Vigas auxil. de base / Half base beams / Halbträger für fundamentkreuz / Semipoutre de châsis de base / Travi di congiunzi di congiunzione</p> 	4,40	0,30	0,55	220

Provisional

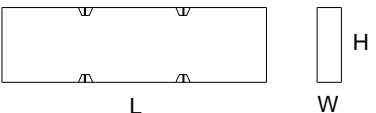
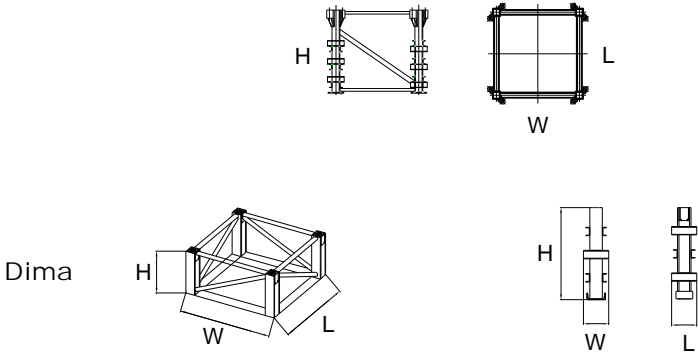
		L(m)	W(m)	H(m)	Peso(Kg)	
Bloque lastre de base / Base ballast block / Grundballastblöcke / Bloc de lest de base Blocco di zavorra alla base 		4,40	0,30	1,20	3800	
Bloque apoyo de base / Base support block / Grundballastblöcke / Bloc de appui de base Blocco di appoggio alla base 		3,75	0,5	1,2	5400	
Elemento de empotre / Foundation anchor / Fundamentanker / Élément de scellement El anegare 		S60/8	1,85	1,85	1,6	956
		S60/R16	1,85	1,85	1,6	1108
		S70/8	2,27	2,27	1,6	1122
		S70R/16	2,27	2,27	1,6	1274
		S75R16/20	0,35	0,35	1,6	1200
		S75R16/22	0,5	0,5	2	2840
		S75R16/26	0,5	0,5	2,4	3160
		S75R24/26	0,5	0,5	2,4	3400
Dima		Dima	2,31	2,34	0,8	1650

Provisional

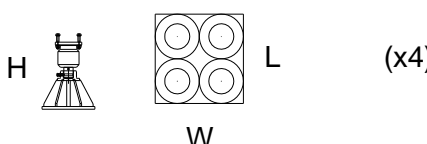
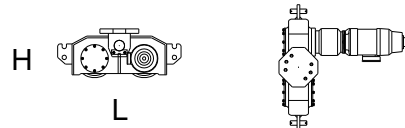
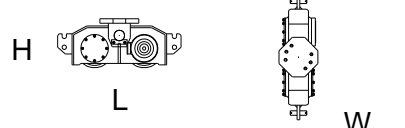
	L(m)	W(m)	H(m)	Peso(Kg)
<p>Niveladores / Levellers / Spindel pyramide / Niveleurs / Piedi regolabile</p> <p>n.° 4</p>  <p>(x4)</p>	1,20	1,20	0,90	250
<p>Traslacion / Travelling bogies / Kranfahren / Traslacion / Traslazione</p>  <p>(x2)</p>	1,15	1,25	0,45	505
 <p>(x2)</p>	1,15	1,25	0,45	450

Provisional

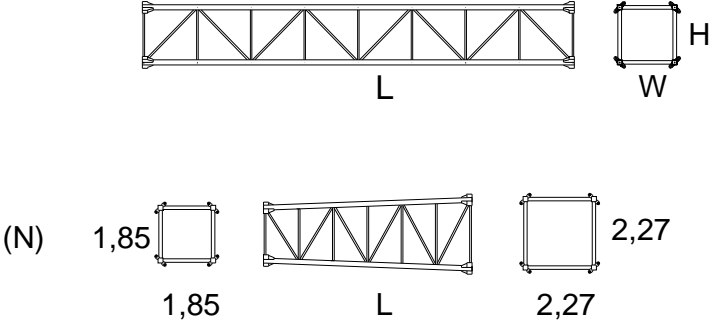
	L(m)	W(m)	H(m)	Peso(Kg)	
Elemento de torre TL16 / Tower section TL16 / Turmstück TL16 / Element de mât TL16 / Elemento di torre TL16					
	K	11,8	1,85	1,85	4600
	K	5,9	1,85	1,85	2472
	K	3	1,85	1,85	1425
	L	11,8	1,85	1,85	5520
	O	11,8	2,27	2,27	5044
	O	5,9	2,27	2,27	2640
	O	3	2,27	2,27	1545
	P	11,8	2,27	2,27	5700
	N	5,9			3500
	X	6	2,27	2,29	4000
	T	6	2,27	2,29	4300
	U	6	2,31	2,34	5910
	Z	6	2,61	2,34	5980

Unidad de rotacion / Complete slewing unit / Drehbühne / Orientation / Rotazione

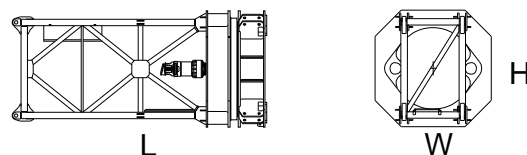

4,40 2,00 2,00 6600

Cabina y soporte / Cabin and support / Kabine und wartungs / Cabine et support / Cabina e supporto

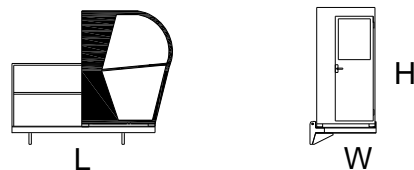

3,00 1,15 2,35 558

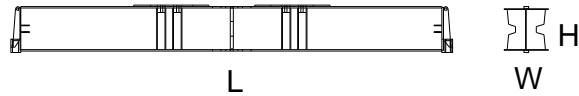
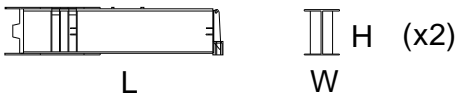
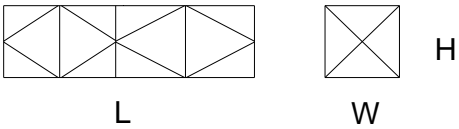
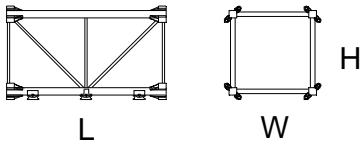
	L(m)	W(m)	H(m)	Peso(Kg)
<p>Viga principal base 6x6 / Main base beam / Hauptträger für fundamentkreuz Poutre de châssis de base / Trave principale della base</p> 	8,65	0,78	0,92	4300
<p>Semiviga secundaria base 6x6 / Half base beam / Halbträger für fundamentkreuz Semipoutre de châssis de base / Semitrave secundaria della base</p> 	4,27	0,68	0,97	2025
<p>Caja de trepado-S17 / Climbing cage / Hydraulikbühne Cage de montage / Gabbia di montaggio</p> 	7,35	2,1	2,1	6400
<p>Tramo trepador / Tower element / Turmstück Element de mature / Elemento di torre monolitico</p> 	3	1,85	1,85	1425

Provisional

ESPECIFICACIONES SUJETAS A MODIFICACIONES SIN PREVIO AVISO.

Specifications subject to modification without notice.

Obiges kann ohne berstaendigung geaendert werden.

Specifications susceptibles de modification sans avis préalable.

Specifiche suscettibili di variazioni senza preavviso.

DECLINAMOS TODA RESPONSABILIDAD DERIVADA DE LA INFORMACION PROPORCIONADA.

This information is supplied without liability.

Sämtliche Angaben erfolgen ohne Gewähr.

Ces renseignements sont sans garantie.

Le indicazioni contenute si intendono salvo errori ed omissioni.